

**STANDARD EXECUTIONS**

AISI 304 stainless steel.

**FEATURES AND APPLICATIONS**

GN 505.5 dowels for T-slots are suitable for use on aluminium sections for quick insert.

Inserting the dowel upright into the T-slot and rotating it clockwise by 90°, the toothing will insert into the profile to secure fitting. To remove the dowel from the slot, rotate it anticlockwise by 90°.

Application example

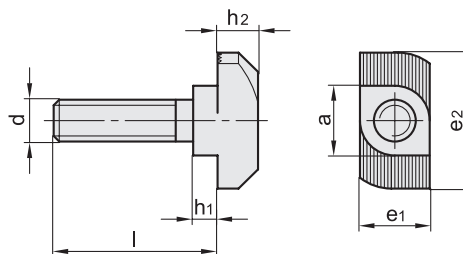
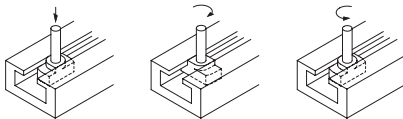

Conversion Table	
1 mm = 0.039 inch	
a	
mm	inch
8	0.31
10	0.39

Code	Description	a-0.1-0.6	d	l	e1	e2	h1	h2	⚖️
GN.24381	GN 505.5-8-M6-20-1.6	8	M6	20	7.9-0.5	16 +0.5/-1	1.6-0.6	5 ±1.0	7
GN.24382	GN 505.5-8-M6-25-1.6	8	M6	25	7.9-0.5	16 +0.5/-1	1.6-0.6	5 ±1.0	10
GN.24383	GN 505.5-8-M6-30-1.6	8	M6	30	7.9-0.5	16 +0.5/-1	1.6-0.6	5 ±1.0	13
GN.24384	GN 505.5-10-M6-20-3.5	10	M6	20	10 0/-2.5	19 +0.5/-1	3.5-1.0	6.5-1.5	9
GN.24385	GN 505.5-10-M6-25-3.5	10	M6	25	10 0/-2.5	19 +0.5/-2	3.5-1.0	6.5-1.5	12
GN.24386	GN 505.5-10-M6-30-3.5	10	M6	30	10 0/-2.5	19 +0.5/-2	3.5-1.0	6.5-1.5	15
GN.24387	GN 505.5-10-M8-20-3.5	10	M8	20	10 0/-2.5	19 +0.5/-2	3.5-1.0	6.5-1.5	10
GN.24388	GN 505.5-10-M8-25-3.5	10	M8	25	10 0/-2.5	19 +0.5/-2	3.5-1.0	6.5-1.5	13

- 1
- 2
- 3
- 4
- 5
- 6
- 7
- 8
- 9
- 10
- 11
- 12
- 13
- 14
- 15
- 16
- 17
- 18